



[anwb.nl/watersport](https://anwb.nl/watersport), de site voor watersporters

**The family man  
who likes racing  
really needs  
two boats**



**or the Contessa 32**



Most people who enjoy sailing know what to look for in a yacht; ease of handling and maintenance, speed through the water, comfort and room to move, safety and practical accommodation.

### **She's easy to handle**

Enjoying a conventional boat can be hard work — but we have used our experience of long-distance cruising and all levels of ocean racing to produce a boat which is really very easy to work. We have used the very best quality fittings to make our Contessa 32 as safe and as efficient as can be.

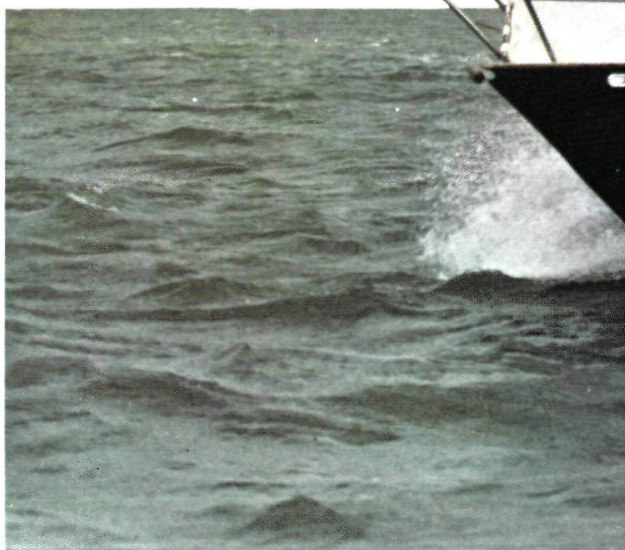

The deck lay-out makes her exceptionally easy to handle: the headsail and spinnaker halyards have been led aft to winches operated from the front of the cockpit, so that these sails can be hoisted and lowered from there, thus minimising the need to move forward. Through mast reefing makes it easy to furl the mainsail and also to reef down to any level very quickly.

These features not only save time when racing but permit a thirty-two foot boat to be handled easily and efficiently by a husband and wife.

### **Our complete price includes other people's extras**

The reasonable price of the Contessa 32 is for the complete boat. Many other boatbuilders in contrast will expect you to purchase extra fittings before you can set sail; fittings which require expense

### **And she's as fast as she looks**

She has won so many races throughout the U.K. that she has a far better record than many out-and-out racers.

The sensation of success can be an extremely pleasant one; ask any Contessa owner, or ask Mike McMullen who finished in the first three in the last Single-handed Transatlantic Race in a 32.





and expert choice. On the Contessa 32 you will find fitted, as standard, features of the highest quality and reliability.

The inventory includes a diesel engine, 3 headsails, a mainsail and seven Lewmar winches, and also an anchor, fenders and warps.



Naturally there may be alterations for which you will be asked to pay extra — the standard interior is mahogany, but you may well prefer teak or sycamore.



### And that's not all

We admit that there are a fair number of yachts on the market which have a similarly roomy cockpit and interior, but the choice becomes more limited when you consider the ability to race and get results.

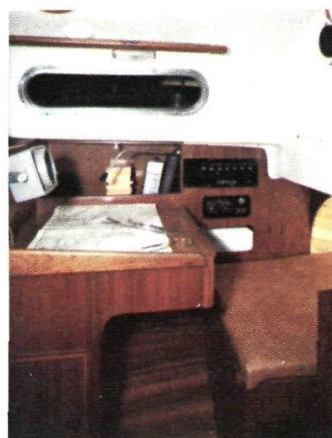

How many other craft possess a chart-table which is large enough to support decent-sized charts? Or really full-sized hanging lockers? Or superb joinery work and upholstery? Or the luxury of a teak cockpit grill? Or six full length berths?

You begin to realise that the Contessa 32 cruiser/racer is unrivalled at her price.

### Construction

The Contessa 32 is built of the finest material under the supervision of Lloyds. The design incorporates a skeg rudder and lead keel.



There are now over 300 of these yachts sailing mostly in the U.K., but as far afield as the Persian Gulf. The owners have formed an Association, which organises races, rallies and social events.

The family man who likes racing and cruising needs a Contessa 32. She's a boat to be proud of.



**J.C. ROGERS Boatbuilders**  
**WATERLOO ROAD**  
**LYMINGTON HAMPSHIRE**  
Telephone 0590 77244



# SPECIFICATION OF THE Contessa 32



<b>Length overall</b>	32 feet	9.75 metres
<b>Length water line</b>	24 feet	7.31 metres
<b>Beam</b>	9 feet 6 ins	2.98 metres
<b>Draft</b>	5 feet 6 ins	1.65 metres
<b>Lead Ballast</b>	4,500 ilbs	2,045 kilos
<b>Windward sail area</b>	562 sq feet	52.2 sq metres
<b>IOR Rating</b>	22.5 feet — 23 feet	

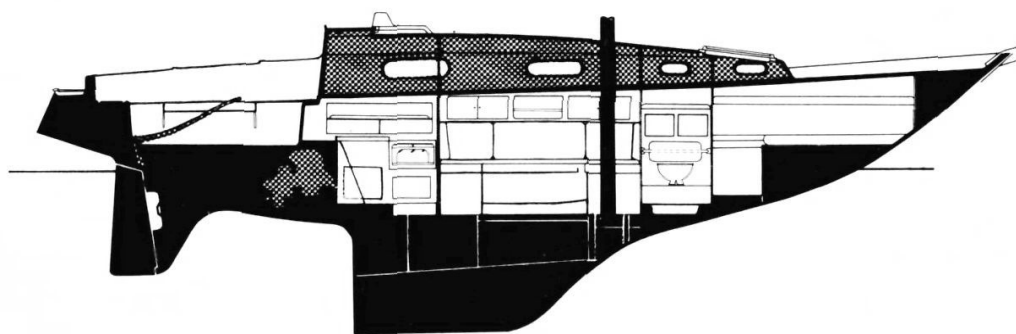
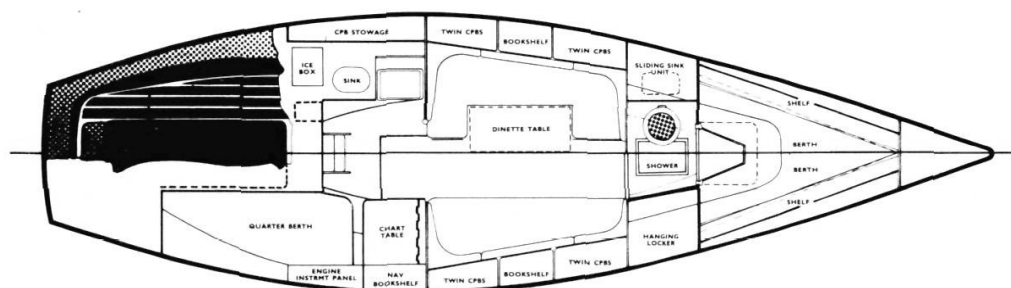

# CONTESSE



